

# Uniden®

OWNER'S MANUAL

**QUICK & EASY  
SET-UP GUIDE**

SEE QUICK  
REFERENCE  
GUIDE  
SECTION

# 900MHz

INTEGRATED DIGITAL ANSWERER  
WITH CALLER ID/CALL WAITING



**EXAI 398 SERIES**

EASILY REGISTER THIS  
PRODUCT ONLINE AT  
[WWW.UNIDEN.COM](http://WWW.UNIDEN.COM)



### Step 1 Checking the Package Contents

Make sure you have received the following items in the package. If any of these items are missing or damaged, contact the Uniden Parts Department.

- Base unit
- Handset
- AC adapter
- Rechargeable battery
- Telephone cord
- Beltclip
- This Owner's Manual
- Other Printed Material

Uniden Parts Department at  
(800) 554-3988  
Hours: M-F 8:00 a.m. to  
5:00 p.m. CST.  
We can also be reached on  
the web at [www.uniden.com](http://www.uniden.com)

### Step 2 Install and Charge the Handset Battery

#### TO INSTALL THE HANDSET BATTERY

- A** Remove the cover.

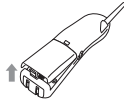

- B** Connect the battery pack connector with the correct polarity.

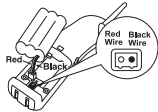

- C** Replace the cover.

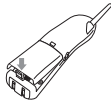

- D** Plug the AC adapter cord into the base unit and then into a 120V AC outlet.

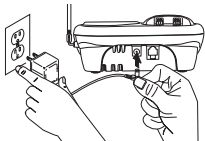

- E** Place the handset on the base and charge continuously for 15 - 20 hours before using the phone.

### Step 3 Connect to Phone Line

#### TO CONNECT TO A PHONE LINE

When the handset battery pack is fully charged, after 15-20 hours of charging, plug the telephone cord into the base unit and then into a telephone wall jack.

Your phone is set for tone dialing. If your local network requires pulse dialing, please see "Choosing the dialing mode" on page 14.

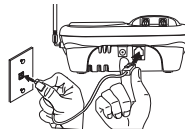

### Step 4 Setting Display Options

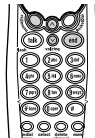

**Note:** Three Caller ID options are available: AutoTalk, Caller ID on Call Waiting (CIDCW), and Area Code.

#### TO SET CALLER ID, LANGUAGE AND DIALING OPTIONS

- A** Press and hold the *cid/menu* key.
- B** Press the *vol/ring/∧* or *vol/ring/∨* key to move the pointer to an option.
- C** Press *select* to change the option setting.
- D** Press *end* to exit, and return the handset to the base.

#### OPTIONS INCLUDE

- A** Auto Talk On/Off
- B** CIDCW (Caller id/call waiting) On/Off
- C** Area Code Enter/Remove
- D** Dial Pulse/Tone
- E** Language Eng/Fr.

### Step 5 Set Answering System

To turn the answering system on, press *ans on/off*.

A pre-recorded greeting will play and your system is ready to accept calls.

To record a personal outgoing greeting to callers, please see page 36.

# Contents

<b>Quick Reference Guide</b>	3	<b>Caller ID Features</b>	
<b>Welcome/Features</b>	5	Caller ID	26
<b>Controls and Functions</b>	6	When the Telephone Rings	26
<b>Getting Started</b>		Viewing the Caller ID Message List	27
Setting up the Phone	8	Deleting Information from the Caller ID List	27
Mounting the Base Unit on a Wall	12	Using the Caller ID List	29
Setting Menu Options	13	<b>The Integrated Answering Device</b>	
<b>Basics</b>		The Integrated Answering Device	30
Making and Receiving Calls	15	Features	30
Adjusting the Handset Ringer and Earpiece Volume	16	Turning the Answering System On/Off	31
Redial	16	Setting Up Your Answering System	31
Tone Dialing Switch-over	16	Using Your Answering System	38
Traveling Out-of-Range	17	<b>Additional Information</b>	
Selecting a Different Channel	17	Changing the Digital Security Code	43
Page	17	Installing the Beltclip	43
Flash and Call Waiting	17	Headset Installation	44
<b>Memory Dialing</b>		Note on Power Sources	44
Storing Phone Numbers and Names	18	Maintenance	44
Steps for Entering Names and Special Characters	20	Troubleshooting	45
Making Calls with Memory Dialing	21	General Information	48
Chain Dialing	22	Precautions & Warranty	49
Editing a Stored Name and/or Phone Number	23	I.C. Notice	51
Erasing a Stored Name and Phone Number	24	Index	52
<b>RocketDial</b>		Remote Operation Card	
RocketDial	24		
Storing and Editing the RocketDial	25		
Making Calls with the RocketDial	25		
Deleting the RocketDial	25		

# Welcome

Congratulations on your purchase of the Uniden EXAI398 series cordless telephone and answering system. This phone is designed and engineered to exacting standards for reliability, long life, and outstanding performance.

**Note: Some illustrations in this manual may differ from the actual unit for explanation purpose. The color of your cordless telephone may vary.**



As an ENERGY STAR® Partner, Uniden has determined that this product or product models meets the ENERGY STAR® guidelines for energy efficiency. ENERGY STAR® is a U.S. registered mark.

# Features

- 900MHz Extended Range Technology
- 16 Digit, 3-line Backlit Display
- Integrated Telephone Answering Device (ITAD)
- Voice Prompted Guidance through ITAD Setup Menu
- 10 Number Memory Dialing
- RocketDial™
- Caller ID and Call Waiting Caller ID
- 30 Number Caller ID Memory
- 32 Digit Redial
- Flash and Pause
- Pulse/Tone Dialing
- Page/Find Handset
- 7 Hour Talk Time/14 Day Standby Time
- Handset Earpiece and Ringer Volume Control
- Hearing Aid Compatible
- 20 Channel Autoscan
- English or French Display Option

**Be sure to visit our web site: [www.uniden.com](http://www.uniden.com)**

Uniden® is a registered trademark of Uniden America Corporation.

AutoTalk, AutoStandby, UltraClear Plus, Random Code, AutoSecure, and RocketDial are trademarks of Uniden America Corporation.

# Controls and Functions

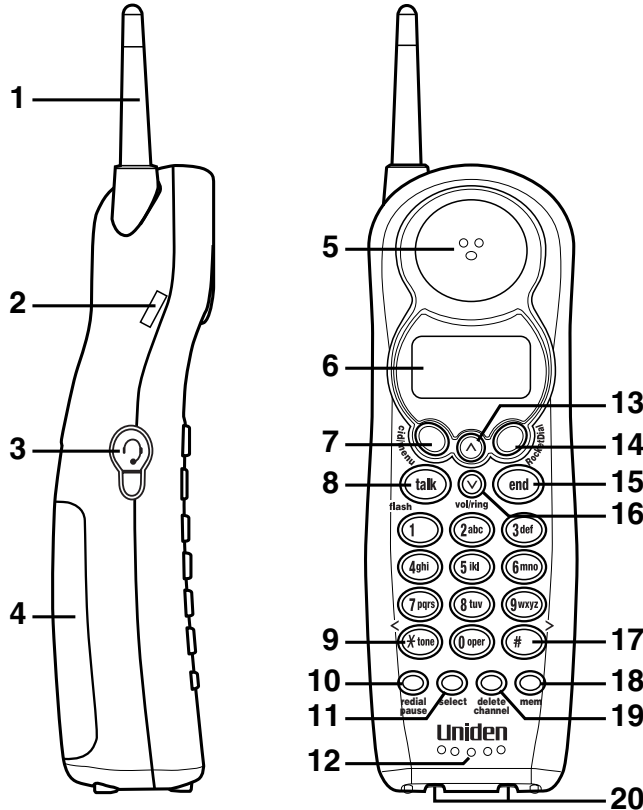

1. Handset antenna
2. Beltclip holes
3. Optional headset jack
4. Handset battery compartment
5. Handset earpiece
6. LCD display
7. (Caller ID) cid/menu key
8. Talk/flash key
9. \* /tone/< (left cursor) key
10. Redial/pause key
11. Select key
12. Handset microphone and ringer speaker
13. (Volume) vol/ring/^ (up) key
14. RocketDial key
15. End key
16. (Volume) vol/ring/v (down) key
17. #/> (right cursor) key
18. (Memory) mem key
19. Delete/channel key
20. Handset charging contacts

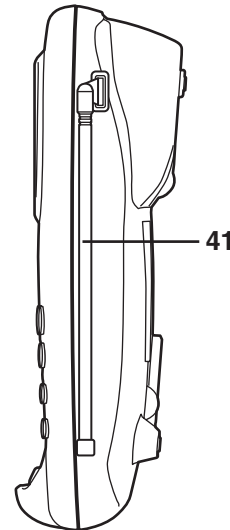
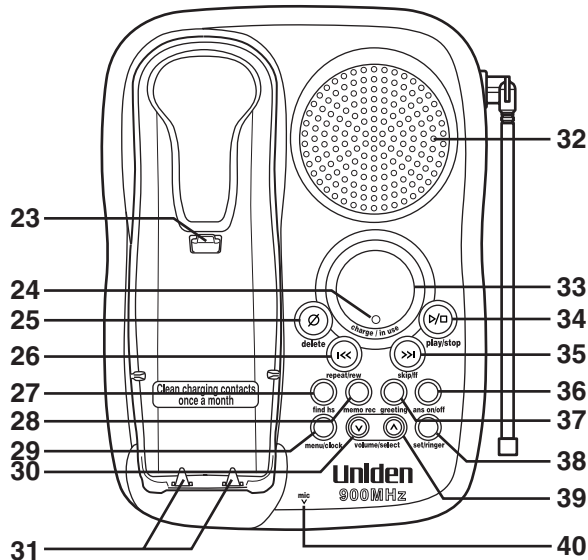
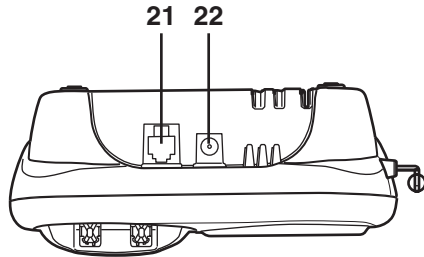

- 21. Telephone line jack
- 22. DC IN 9V jack
- 23. Handset retainer clip
- 24. Charge/in use LED
- 25. Delete/∅ key
- 26. Repeat/rew (rewind)/◀◀ key
- 27. Find hs (handset) key
- 28. Memo rec (record) key
- 29. Menu/clock key
- 30. Volume/select/∇ (down) key
- 31. Base charging contacts
- 32. Base speaker
- 33. Message counter display
- 34. Play/stop ▶◻ key
- 35. Skip/ff (fast forward)/▶▶ key
- 36. (Answer) ans/on/off key
- 37. Greeting key
- 38. Set/ringer key
- 39. Volume/select/∧ (up) key
- 40. (Microphone) mic
- 41. Base antenna



If your home has specially wired alarm equipment connected to the telephone line, be sure that installing the system does not disable your alarm equipment.

If you have questions about what will disable your alarm equipment, contact your telephone company or a qualified installer.

# Setting up the Phone

## Do the following steps:

- A. Choose the best location
- B. Install the rechargeable battery pack into the handset
- C. Connect the base unit

### A. Choose the best location

Before choosing a location for your new phone, read the **INSTALLATION CONSIDERATIONS** included in the **PRECAUTIONS AND IMPORTANT SAFETY INSTRUCTIONS**. Here are some important guidelines you should consider:

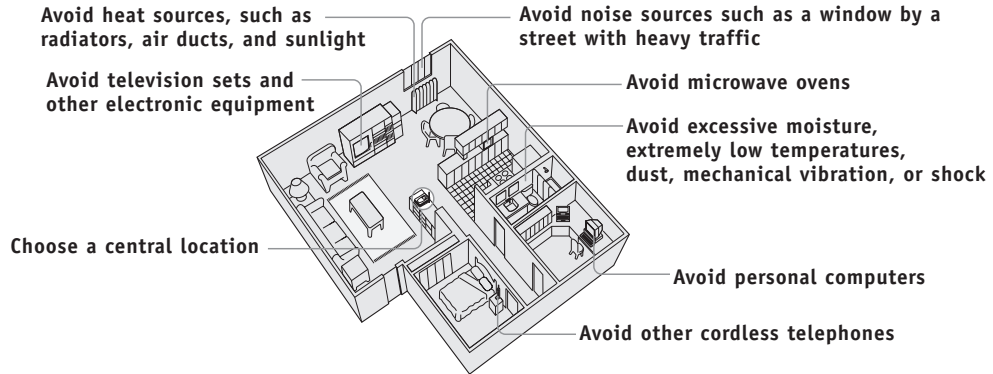

- The location should be close to both a phone jack and a continuous power outlet which is not switchable.
- Keep the base and handset away from sources of electrical noise such as motors, microwave ovens, and fluorescent lighting.
- Be sure there is sufficient space to raise the base antenna to a vertical position.
- The base can be placed on a desk, tabletop, or mounted on a standard wall plate.



## B. Install the rechargeable battery pack into the handset

The handset is powered by a rechargeable battery pack.

The battery recharges automatically when the handset is placed on the base unit.

**Charge the handset battery pack for at least 15-20 hours before using your new cordless telephone for the first time!** To maximize the charge capacity of your battery pack, DO NOT plug the telephone cord into the base unit and wall jack until the battery is fully charged.

1) Press up on the latch and lift the battery cover.

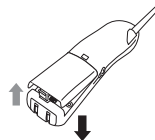

2) Connect the battery pack connector observing correct polarity (black and red wires) to the jack inside the battery compartment.

Do not exert any force on this connection. It could cause damage to the battery or handset. Once you are certain that you have made a good connection, then insert the battery pack into the battery compartment. Do not pinch the wires.

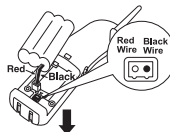

3) Insert the tabs of the cover into the slots of the battery compartment and securely close the cover by pressing down.

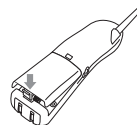

4) Place the handset on the base.

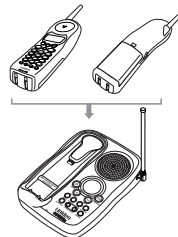

- Use only the Uniden (BT-905) rechargeable battery pack supplied with your cordless telephone.
- Replacement batteries are also available through the Uniden Parts Department at (800) 554-3988, Monday thru Friday from 8:00 a.m. to 5:00 p.m. or online at [www.uniden.com](http://www.uniden.com)
- Recharge your phone on a regular basis by returning the handset to the base after each phone call.



- Even when the battery pack is not being used, it will gradually discharge over a long period of time. For optimum performance, be sure to return the handset to the base unit after a telephone call.
- **Talk Mode** - The handset is off the base and *talk/flash* has been pressed enabling a dial tone.
- **Standby Mode** - The handset is not in use, off the base and *talk/flash* has not been pressed. A dial tone is not present.

## Battery use time (per charge)

From fully charged (15-20 hours charge time)

- Up to seven hours continuous use during talk mode.
- Up to fourteen days when the handset is in the standby mode.

## Low battery alert

When the battery pack is very low and needs to be charged, the phone is programmed to eliminate functions in order to save power. If the phone is not in use, "Low Battery" appears on the LCD and none of the keys will operate.

If the phone is in use, "Low Battery" flashes and the handset beeps. Complete your conversation as quickly as possible and return the handset to the base unit for charging.

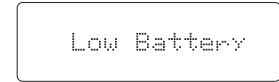

The last number dialed in the redial memory and the numbers stored in the memory locations are retained for up to 30 minutes while you replace the battery pack.

## Cleaning the charging contacts

To maintain a good charge, it is important to clean the charging contacts on both the handset and base unit once a month. Use a dry cloth or pencil eraser to clean. If the contacts become very dirty, using water only, dampen a cloth to clean the charging contacts. Then make sure to go back over the charging contacts with a dry cloth before returning the handset to the base to charge.

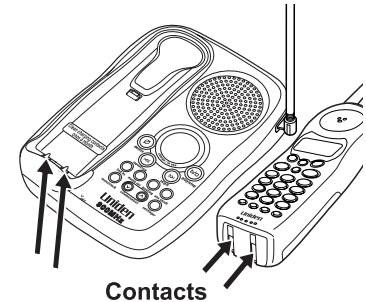

### C. Connect the base unit

- 1) Connect the AC adapter to the **DC IN 9V** jack and to a standard 120V AC wall outlet.
- 2) Set the base on a desk or tabletop, and place the handset on the base unit as shown. (For wall mounting, see "Mounting the Base Unit on a Wall", on page 12.)
- 3) Raise the antenna to a vertical position.
- 4) Make sure the **charge/in use** LED illuminates. If the LED does not illuminate, check to see that the AC adapter is plugged in and the handset makes good contact with the base charging contacts.



- Connect the AC adapter to a continuous power supply.
- Place the base unit close to the AC outlet so that you can unplug the AC adapter easily.

- After installing the battery pack in the handset, charge your handset at least **15-20 hours before plugging into the phone line.**

- 5) Once the handset battery pack is fully charged, connect the telephone line cord to the **TEL LINE** jack and a telephone outlet.



If your telephone outlet isn't modular, contact your telephone company for assistance.

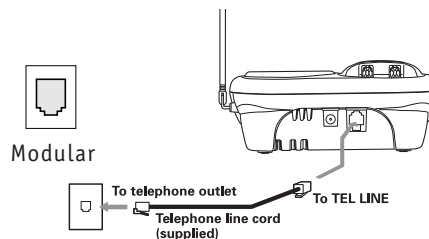
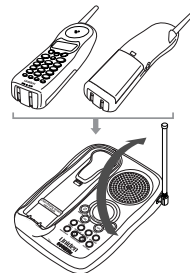
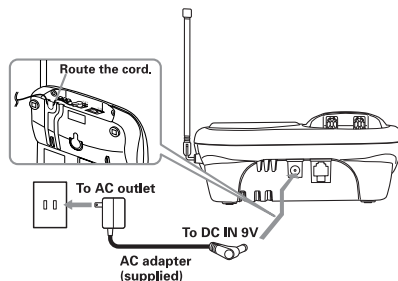

- Use only the supplied **AD-314 AC adapter.** Do not use any other AC adapter.
- Place the power cord so that it does not create a trip hazard or where it could become chafed and create a fire or electrical hazard.



The handset can be placed face up or face down on the base for charging.

# Mounting the Base Unit on a Wall

## Standard wall plate mounting

This phone can be mounted on any standard wall plate.

- 1) Plug the AC adapter to the **DC IN 9V** jack.
- 2) Wrap the AC adapter cord inside the molded wiring channel as shown.
- 3) Plug the AC adapter into a standard 120V AC wall outlet.
- 4) Plug the telephone line cord into the **TEL LINE** jack. Wrap the cord inside the molded wiring channel as shown.
- 5) Plug the telephone line cord into the telephone outlet.
- 6) Raise the antenna to a vertical position.
- 7) Align the mounting slots on the base with the mounting posts on the wall. Then push in and down until the phone is firmly seated.

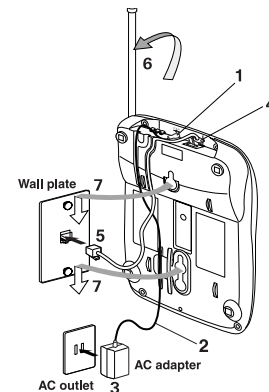

## Direct wall mounting

If you don't have a standard wall plate, you can mount your phone directly to the wall. Before doing this, consider the following:

- Avoid electrical cables, pipes, or other items behind the mounting location that could cause a hazard when inserting screws into the wall.
- Try to mount your phone within 5 feet of a working phone jack to avoid excessive cord lengths.
- Make sure the wall material is capable of supporting the weight of the base and handset.
- Use #10 screws (minimum length of 1-3/8 inches) with anchoring devices suitable for the wall material where the base unit will be placed.

- 1) Insert two mounting screws into the wall, (with their appropriate anchoring device), 3-15/16 inches apart. Allow about 1/8 of an inch between the wall and screw heads for mounting the phone.

- 2) Refer to steps 1 through 7 above.

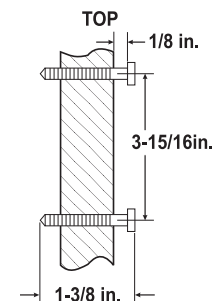

DO NOT use an AC outlet controlled by a wall switch.

# Setting Menu Options

There are five setup options available. They are Caller ID options [AutoTalk, CIDCW (Caller ID on Call Waiting), and Area Code], Dial Mode and Language.

AutoTalk allows you to answer the phone without pressing the **talk/flash** key. If the phone rings when AutoTalk is on, simply remove the handset from the base and the phone automatically answers the call. If the phone rings when AutoTalk is off, you must press **talk/flash** to answer the call.

## Caller ID options

To change your AutoTalk and CIDCW:

- 1) Press and hold **cid/menu**. The following screen appears.
- 2) Use the **vol/ring/∧** or **vol/ring/∨** key, or a number key (1 and 2) to move the pointer to the selection that you would like to change. Press **select** to toggle between “On” and “Off” for Auto Talk and CIDCW.
- 3) Press **end** and return the handset to the base unit to complete the setting. The handset returns to the standby mode.

```
1# Auto Talk: Off
2 CIDCW       : On
3 Area Code#
```

To enter your Area Code

If you enter a 3-digit area code number in the **Area Code** option, your local area code does not appear in Caller ID messages. Do not program this option, if your calling area requires 10-digit dialing. When reviewing Caller ID messages, you will see only the local seven digit number. For calls received from outside your local area code, you will see a full 10-digit number. If your calling area requires 10-digit dialing, do not program this option.

- 1) When the phone is in the standby mode, press and hold **cid/menu**. The following screen appears.
- 2) Press **3** or press the **vol/ring/∨** key twice to select “Area Code”.
- 3) Press **select**.

```
1# Auto Talk: Off
2 CIDCW       : On
3 Area Code#
```

```
1 Auto Talk: Off
2 CIDCW     : On
3# Area Code#
```

note

The cordless phone features include **AutoTalk™** and **AutoStandby™**. AutoStandby allows you to hang up by simply returning the handset to the base.

- 4) Use the number keys (**0 - 9**), **#/>**, **\*/tone/<**, or **delete/channel** to enter the 3-digit area code.
- 5) Press **select**. A confirmation tone sounds and the displayed area code is entered.
- 6) Press **end** or return the handset to the base unit to complete the setting. The handset returns to the standby mode.

```

1 Auto Talk:Off
2 CIDCW      :On
3 Area Code:

```



When the area code has already been stored in memory, the stored area code will be displayed. To change it, use the **delete/channel** and number keys to enter the new area code. Then press **select**. A confirmation tone sounds. To complete the setting, press **end** or return the handset to the base unit.

```

1 Auto Talk:Off
2 CIDCW      :On
3 Area Code:817

```

### Choosing the dialing mode

Most phone systems use tone dialing which sends DTMF tones through the phone lines. However, some phone systems still use pulse dialing such as in rural areas. The default setting is tone dialing. Depending on your dialing system, set the mode as follows:

- 1) When the phone is in the standby mode, press and hold **cid/menu**. The following screen appears.
- 2) Press **4** or press the **vol/ring/v** key three times to select "Dial".
- 3) Press **select** to toggle between "Tone" and "Pulse".
- 4) Press **end** or return the handset to the base unit to complete the setting. The handset returns to the standby mode.

```

1 Auto Talk:Off
2 CIDCW      :On
3 Area Code:

```

```

2 CIDCW      :On
3 Area Code:
4 Dial      :Tone

```

### Setting the language

- 1) When the phone is in the standby mode, Press and hold **cid/menu**. The following screen appears.
- 2) Press **5** or press the **vol/ring/v** key four times to select "Language".
- 3) Press **select** to toggle between "Eng" and "Fr. ".
- 4) Press **end** or return the handset to the base unit to complete the setting. The handset returns to the standby mode.

```

1 Auto Talk:Off
2 CIDCW      :On
3 Area Code:

```

```

3 Area Code:
4 Dial      :Tone
5 Language  :Eng

```



- If you are not sure of your dialing system, make a trial call. If the call connects, leave the setting as is, otherwise set for pulse dialing.
- If your phone system requires pulse dialing and you need to send the DTMF tones for certain situations during a call, you may "switch-over" to tone dialing (refer to "Tone Dialing Switch-over" on page 16).

# Making and Receiving Calls

	Handset On Base	Handset Off Base
To answer a call	Pick up the handset (AutoTalk: On), or pick up the handset and press <b>talk/flash</b> . (AutoTalk: Off)	Press <b>talk/flash</b> , any number, <b>*/tone/&lt;</b> or <b>#/&gt;</b> . (AutoTalk: On)
To make a call	1) Pick up the handset. 2) Press <b>talk/flash</b> . 3) Listen for the dial tone. 4) Dial the number.  <b>OR</b>	1) Press <b>talk/flash</b> . 2) Listen for the dial tone. 3) Dial the number.  <b>OR</b>
	1) Pick up the handset. 2) Dial the number, then press <b>talk/flash</b> .	Dial the number, then press <b>talk/flash</b> .
To hang up	Press <b>end</b> or return the handset to the base (AutoStandby).	
To redial	1) Pick up the handset. 2) Press <b>talk/flash</b> . 3) Listen for the dial tone. 4) Press <b>redial/pause</b> .  <b>OR</b>	1) Press <b>talk/flash</b> . 2) Listen for the dial tone. 3) Press <b>redial/pause</b> .  <b>OR</b>
	1) Pick up the handset. 2) Press <b>redial/pause</b> , then press <b>talk/flash</b> .	Press <b>redial/pause</b> , then press <b>talk/flash</b> .



Refer to page 13 "Setting Menu Options" to turn on the AutoTalk feature if desired.

# Adjusting the Handset Ringer and Earpiece Volume

## Handset ringer tone and volume

Press the volume up key or volume down key (labeled as, *vol/ring/∧* and *vol/ring/∇*) in standby mode to select one of five ringer tones and volume combinations.

## Earpiece volume

Pressing the volume up key or volume down key (labeled as, *vol/ring/∧* and *vol/ring/∇*) during a call will change the earpiece volume of the handset. This setting will remain in effect after the telephone call has ended.

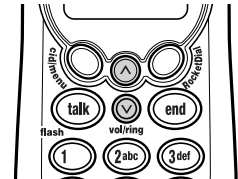

When you press the *vol/ring/∧* key in Maximum mode or the *vol/ring/∇* key in Low mode, an error tone sounds.

## Temporarily Mute Ringer

If the handset is off the base, simply press the *end* key to temporarily mute the incoming ring. The ringer will sound with the next incoming call.

## Redial

The *redial/pause* key redials the last number dialed. The redialed number can be up to 32 digits long.



- The tone feature only applies when the dial mode is set to pulse.
- This special number can be stored in a memory location. This is referred to as Chain Dialing (see page 22.)

## Tone Dialing Switch-over

Some telephone companies use equipment that requires pulse dialing (sometimes referred to as rotary dialing). If you need to enter tone dialing digits, you can switch-over to tone dialing during the call. For example, entering your bank account number after you have called your bank.

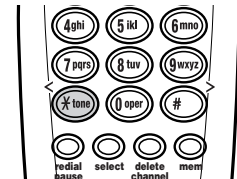

Initially make your call with the pulse dialing mode. Once your call connects, press *\*/tone/⟨*. Enter the desired number. These digits will be sent as tone dialing. Once the call ends, the tone mode is canceled and pulse dialing mode resumes.



# Traveling Out-of-Range

During a call, as you begin to move your handset too far from your base unit, noise increases. If you pass the range limits of the base unit, your call will terminate within 5 minutes.

# Selecting a Different Channel

If you encounter interference while using your phone, you can manually change the phone's channel for clear operation. This function works only when the phone is in use. Press **delete/channel**. "Scanning" appears on the display, indicating the phone is changing to another channel. For more information on interference, refer to page 50.

# Page

To locate the handset (while it's off the base), press **find hs** on the base. The handset beeps for 60 seconds.

Paging is canceled when pressing any handset key, **find hs** on the base or the handset is returned to the base.

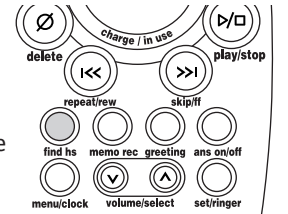

# Flash and Call Waiting

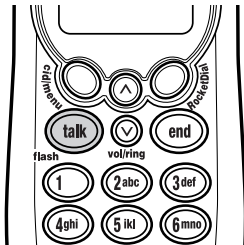

If you have "Call Waiting" service and a call waiting tone sounds while you are on a call, press **talk/flash** to accept the waiting call. There is a short pause, then you will hear the new caller. To return to the original caller, press **talk/flash** again.



You must subscribe through your local telephone company to receive Call Waiting Service.



- The **UltraClear Plus™** true compander circuitry virtually eliminates background noise. This innovative technology, together with 20 different channels, provides you with the best possible reception during all your conversations.
- Paging is also canceled when the phone receives an incoming call.



## Storing Phone Numbers and Names

Memory Dialing allows you to dial a number using just a few key presses. Your cordless telephone stores up to 10 names/numbers in the handset.

- In memory dialing operation, you must press a key within 30 seconds. Otherwise, an error tone will sound and the phone will return to standby. If you return the handset to the base, the phone will return to standby also.
- You have 30 seconds after pressing **mem** to enter the number you wish to store. Otherwise, an error tone will sound.

- 1) Press and hold **mem** until “Memory Store” is displayed.
- 2) Press the **vol/ring/∧** or the **vol/ring/∨** key, or enter a number (**0 - 9**) to select the memory location where you would like to store the number.
- 3) Press **select**. The following screen appears and a cursor flashes indicating that the display is ready for the name to be entered.

If this screen appears, the selected memory location is already stored. Then you must either edit the entry in this location, delete the entry in this location, or select “Go Back” to choose another location.

- 4) To enter a name (up to 14 characters), use number keys.
  - See the “Steps for Entering Names and Special Characters”. (See page 20)
  - Use **#/>** and **\*/tone/<** to move the cursor to the desired location.
  - Use **delete/channel** to delete characters as needed.
  - Press and hold **delete/channel** to delete all the characters.
  - If a name is not required, go to step 5.

- 5) Press **select**. “Store Number” is displayed. The cursor flashes indicating that the display is ready for the number to be entered.

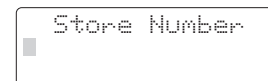
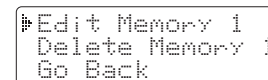
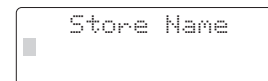
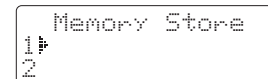

- 6) Use the number keys to enter the phone number.  
The phone number cannot exceed 20 digits.
- Use **redial/pause** to enter a pause in the dialing sequence.  
The display shows a “P”. Each pause counts as one digit and represents a two second delay of time between the digits as they are sent.
  - Use **delete/channel** to delete digits as needed.
- 7) Press **select**. You will hear a confirmation tone and the following display appears. Memory storage is complete. For example, if you store a name and number into memory location number 7, the display shows “Memory 7 Stored”. After about 2 seconds, “Memory Store” is displayed.  
Repeat steps 2 - 7 to store more numbers.
- 8) Press **end** to return to standby mode.

```
Store Number  
0007303456
```

```
Memory 7 Stored
```

```
Memory Store  
7▶Movies  
8 (Memory 8)
```



- The pause feature is useful for long distance calling, credit card dialing, or sequences that require a pause between digits.
- The pause key counts as one digit. Pressing **redial/pause** more than once increases the length of a pause between numbers.
- The 10 memory locations are represented by the numbers 0-9 on the keys. If you store a number in one of the locations, then attempt to store a different number in the same location later, the new number will overwrite the previous one.



If the next character uses the same number key, you must press **#/>** to move the cursor over. Otherwise the next time you press the number key, it changes the character that was previously set.

# Steps for Entering Names and Special Characters

Refer to the letters on the number keys to select the desired characters.

With each press of a numeric key, the displayed character appears in the following order: Upper case letters first, lower case letters next and finally the number corresponding to the key.

## If you make a mistake while entering a name

Use the **\*/tone/<** or **#/>** key to move the cursor to the incorrect character.

Press **delete/channel** to erase the wrong character, then enter the correct character.

To delete all characters, press and hold **delete/channel**.

For example, to enter **Movies**.

- 1) Pick up the handset. Press and hold **mem**.
- 2) Enter a number or press the **vol/ring/^** or **vol/ring/v** key to select a memory location.
- 3) Press **select**. (When there is information already stored in the selected memory location, "Edit Memory XX" is displayed. See page 23 for information on "Editing a Stored Name and/or Phone Number".)
- 4) Press **6** then press **#/>** to move the cursor to the right.
- 5) Press **6** six times.
- 6) Press **8** six times.
- 7) Press **4** six times.
- 8) Press **3** five times.
- 9) Press **7** eight times.
- 10) When finished, press **select**.

keys	Number of times key is pressed								
	1	2	3	4	5	6	7	8	9
<b>1</b>	1								
<b>2</b>	A	B	C	a	b	c	2		
<b>3</b>	D	E	F	d	e	f	3		
<b>4</b>	G	H	I	g	h	i	4		
<b>5</b>	J	K	L	j	k	l	5		
<b>6</b>	M	N	O	m	n	o	6		
<b>7</b>	P	Q	R	p	q	r	s	7	
<b>8</b>	T	U	V	t	u	v	8		
<b>9</b>	W	X	Y	w	x	y	z	9	
<b>0</b>	*	#	-	&	<	>	(blank)	0	

To continue to store the telephone number, proceed to step 6 on page 19.

# Making Calls with Memory Dialing

## Memory dialing from Standby Mode

- 1) Press **mem**. The handset displays your programmed memory locations.
- 2) Press the **vol/ring/∧** or **vol/ring/∨** key, or enter a number (0 - 9) to select the memory location you would like to dial.
- 3) Press **talk/flash**. "Talk" and the volume setting appears on the display. Then the displayed number is dialed.

```
1▶Movies
2 JOHN DOE
3 MOM AND DAD
```

```
-Talk-
8007303456
```

## Display a programmed number

Use **#/>** and **\*/tone/<** to toggle between the names display and the numbers display.

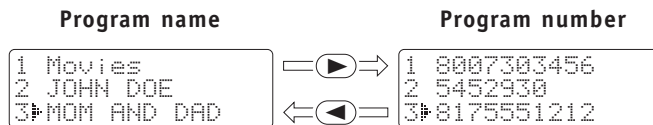

When the stored phone number has 15 or more digits, "➔" is displayed next to the 13th digit. Press **#/>** to see the extra digits and **\*/tone/<** to return.

```
5 012345678901
6▶011813554329+
7
```



- If you press **select** before **talk/flash**, you can confirm the name and the number stored in the selected memory location.
- To exit the memory function without dialing, press **end**. The handset returns to standby.
- Whenever you are using a memory menu screen, you must press a key within 30 seconds or the phone will return to standby.



If you select a memory location that does not have a stored number, an error tone sounds and the phone will not dial.

## Memory dialing from Talk Mode

1) Press **talk/flash**. "Talk" and the volume setting appears.

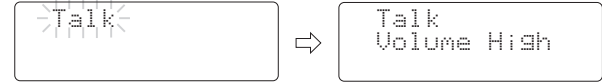

2) Press **mem**.



3) Enter a number (**0 - 9**) to select the memory location of the desired phone number. The selected phone number is displayed. Then the number is dialed.



4) To hang up, press **end**.

## Chain Dialing

The memory locations on the handset are not limited to phone numbers. You can also store a group of numbers (up to 20 digits) that you need to enter once your call connects. This is referred to as Chain Dialing.

An example of this is a bank account number. Once you have called your bank, and are prompted to enter the account number, simply press **mem** and the location number where the special number has been stored.

Store your special number with an identifying name. (Refer to "Storing Phone Numbers and Names" on page 18.)

# Editing a Stored Name and/or Phone Number

- 1) Press and hold **mem** until "Memory Store" is displayed.
- 2) Press the **vol/ring/∧** or **vol/ring/∨** key, or enter a number (0 - 9) to select the memory location you would like to edit.

```
Memory Store
1# Movies
2 JOHN DOE
```

- 3) Press **select**.  
The following screen appears with the memory location number that you have selected in the display.

```
# Edit Memory 1
Delete Memory 1
Go Back
```

- 4) Press the **vol/ring/∧** or **vol/ring/∨** key to select "Edit Memory", then press **select**. The following screen appears. The cursor flashes indicating that the display is ready for the name to be edited. When a name has not been stored, the cursor appears at the beginning of the second line.

```
Store Name
Movies█
```

- 5) Use the number keys, **\*/tone/<**, **#/>**, or **delete/channel** to edit the name.  
(See page 18.) To edit only the phone number, skip this step.

- 6) Press **select**. The following screen appears.  
The cursor flashes indicating that the display is ready for the number to be edited.

```
Store Number
8007303456█
```

- 7) Use the number keys, **redial/pause** or **delete/channel** to edit the phone number.  
The phone number cannot exceed 20 digits. (See page 19.)  
If you don't want to change the phone number, skip this step.

```
Memory 1 Stored
```

- 8) Press **select**. You hear a confirmation tone and the following display appears. The memory storage is complete.  
For example, if you store a name and number into memory location number 1, the display shows "Memory 1 Stored". After about 2 seconds, "Memory Store" is displayed.

```
Memory Store
1# Movies
2 JOHN DOE
```

- 9) Press **end** to return to standby mode.

# Erasing a Stored Name and Phone Number

- 1) Press and hold **mem** until "Memory Store" is displayed.
- 2) Press the **vol/ring/∧** or **vol/ring/∨** key, or enter a number (**0 - 9**) to select the memory location you would like to erase.
- 3) Press **select**.  
The following screen appears with the memory location number that you have selected in the display.
- 4) Press the **vol/ring/∨** key to move the pointer down to "Delete Memory".
- 5) Press **select**. The following confirmation screen appears.
- 6) Press the **vol/ring/∧** key to move the pointer to "Yes".
- 7) Press **select** or **delete/channel**.  
You hear a confirmation tone and the following screen appears.
- 8) After about 2 seconds the display returns to the "Memory Store" screen. You may delete the information in another memory location (return to step 2) or press **end** to return to standby mode.

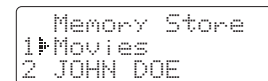

```
Memory Store
1 Movies
2 JOHN DOE
```

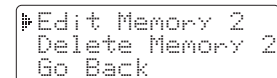

```
Edit Memory 2
Delete Memory 2
Go Back
```

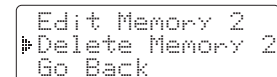

```
Edit Memory 2
Delete Memory 2
Go Back
```

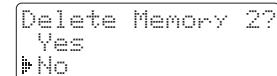

```
Delete Memory 2?
Yes
No
```



```
Memory 2 Deleted
```

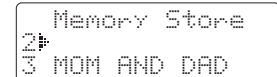

```
Memory Store
2
3 MOM AND DAD
```

## RocketDial

You can store your most frequently dialed number in the RocketDial location. The RocketDial allows you to dial a number with one key press. (There is no need to press **talk/flash**. The phone will automatically dial the number stored.)

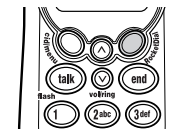



# Storing and Editing the RocketDial

- 1) When the phone is in the standby mode, press and hold **RocketDial**.  
Following display appears.

If this screen appears, there is a number already stored. Press the **vol/ring/∧** or **vol/ring/∨** key to select "Edit Number", then press **select**.

- 2) Store the number by following step 6 under "Storing Phone Numbers and Names" on page 19.
- 3) Press **select**.  
You hear a confirmation tone and displays the following screen.  
Memory storage is complete. The handset returns to standby mode.

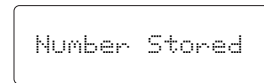
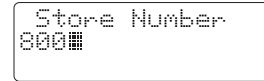
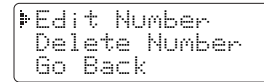
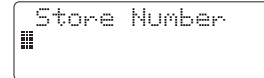

# Making calls with the RocketDial

When the phone is in the standby mode, simply press **RocketDial**. The number stored in the RocketDial memory location is instantly dialed.

# Deleting the RocketDial

- 1) When the phone is in the standby mode, press and hold **RocketDial**.  
Following display appears.
- 2) Press the **vol/ring/∧** or **vol/ring/∨** key to select "Delete Number".
- 3) Press **select**. Following display appears.
- 4) Press the **vol/ring/∧** key to move the pointer to "Yes".
- 5) Press **select** or **delete/channel**.  
You hear a confirmation tone and the following display appears.  
The handset returns to standby mode.

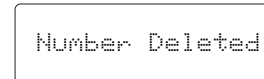
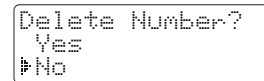
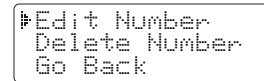

- **RocketDial™** is a one touch speed dial key that automatically dials your most important or frequently called number. The number dialed, is a preset number stored by the user.
- Number stored in RocketDial is independent from the numbers stored in Memory Dial.
- If the RocketDial does not have a stored number, the handset will beep rapidly and the phone will not dial.



- If you answer a call before the Caller ID message is received (Example: before the second ring), the Caller ID message will not appear.
- When the call is received via a telephone company that does not offer Caller ID service, the caller's phone number and name do not appear. (This includes international calls.)
- When the call is via a private branch exchange (PBX), the caller's phone number and name may not appear.

## Caller ID

**You must subscribe to Caller ID service to use this feature.**

When the telephone rings, the Caller ID feature allows you to view the caller's name and phone number on the display before you answer the phone.

The handset displays the phone number of the incoming call, the name, and time. Additionally, you can dial the displayed number and store the information for memory dialing. Make sure you have turned on the Caller ID/Call Waiting feature. (See page 13.)

## When the Telephone Rings

- 1) When the Caller ID message is received, the display shows the caller's phone number along with the date and time. The incoming call information is stored in the Caller ID record. If the Caller ID service includes the caller's name, the caller's name appears on the display (up to 15 letters).

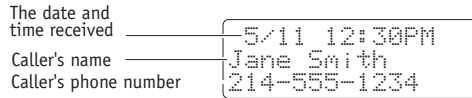

You may receive any one of the following messages:

When invalid data is received	"Incomplete Data"
When a private name is received	"Private Name"
When a private number is received	"Private Number"
When a unknown name is received	"Unknown Name"
When a unknown number is received	"Unknown Number"

- 2) When you pick up the phone, the display changes to "Talk". (AutoTalk feature is set to on.)



Data errors appear as "■".

# Viewing the Caller ID Message List

The Caller ID list stores information for up to 30 incoming calls - even unanswered calls.

1) Press ***cid/menu***.

The summary screen appears. This screen shows the number of new messages and total messages.

```
New :01
Total:02
```

2) Press the ***vol/ring/∧*** or ***vol/ring/∨*** key to display the oldest or latest Caller ID message.

```
5/17 12:30PM 03
Jane Smith
214-555-1234
```

3) Press the ***vol/ring/∨*** key to see the next message. Or press the ***vol/ring/∧*** key to see previous message.

4) Press ***end*** to return to standby mode.

## Deleting Information from the Caller ID List

The phone stores up to 30 messages. If the phone receives the 31st message, the oldest one in the list is automatically deleted. Caller ID data can also be deleted manually.

### Deleting a Caller ID message

1) Press ***cid/menu***. Display the message to be deleted from the Caller ID list by pressing the ***vol/ring/∧*** or the ***vol/ring/∨*** key.

```
5/17 12:30PM 03
Jane Smith
214-555-1234
```

2) Press ***delete/channel***.

3) Press the ***vol/ring/∧*** or the ***vol/ring/∨*** key to select "Yes" or "No".

```
Delete Message?
▶ Yes
No
```



- In Caller ID operation, if no key is pressed for more than 30 seconds, an error tone sounds and the telephone returns to the standby mode.
- If a call comes in via a telephone system that does not offer Caller ID service, no information is stored.
- Each message can be up to 15 characters for the phone number and the name.
- The number of calls from the same Caller ID appears next to the received time. Once you read the new message, the number will be cleared and disappear.



- While using the "Delete All?" or "Delete Message?" screen if no key is pressed for more than 30 seconds, an error tone sounds and the telephone returns to standby.
- If you get an incoming call or page, the deleting operation is canceled so you can answer the call or page.

4) Press ***select*** or ***delete/channel***.

**When the pointer is at "Yes":**

You hear a confirmation tone and the Caller ID message is deleted. The next Caller ID message is then displayed.

**When the pointer is at "No":**

The display returns to the Caller ID message.

### Deleting all Caller ID names/numbers

1) Press ***cid/menu***.

2) Press ***delete/channel***.

3) Press the ***vol/ring/∧*** or the ***vol/ring/∨*** key to select "Yes" or "No".

4) Press ***select*** or ***delete/channel***.

**When the pointer is at "Yes":**

You hear a confirmation tone and all stored Caller ID messages are deleted.

**When the pointer is at "No":**

The display returns to the summary screen.

```
New :01
Total:02
```

```
Delete All?
  Yes
▶No
```

```
Total:00
```

```
New :01
Total:02
```

# Using the Caller ID List

## Calling a party from the Caller ID list

You can place a call from the Caller ID list. The phone stores up to 30 messages.

- 1) Press **cid/menu**. Select the phone number that you want to dial by pressing the **vol/ring/∧** or **vol/ring/∨** key.
- 2) Press **talk/flash**. The displayed phone number dials automatically.

```
5/17 12:30PM 03  
Jane Smith  
214-555-1234
```

```
Talk  
2145551234
```

## Long Distance calls and Area Code Setting/Cancellation

Pressing **1** while the incoming Caller ID information is displayed (in step 1) will place the prefix "1" in the display to setup for a long distance call. Pressing **3** will set or cancel an area code setting.

## Dial edit

You can temporarily edit the Caller ID number that is displayed by pressing **select**. A cursor appears in the display. Press **delete/channel** to move the cursor left, make your changes, and then press **talk/flash**. This will not change the number in the Caller ID list memory.

## Storing Caller ID messages in Memory dialing

Messages shown in the Caller ID list can be stored in memory dialing. Using the incoming call information (i.e., Caller ID list), the phone number of the party on the Caller ID list can be stored in memory.

- 1) Press **cid/menu**.  
Select the phone number to be stored from the Caller ID list by pressing the **vol/ring/∧** or **vol/ring/∨** key.
- 2) Press **mem**.
- 3) Press the **vol/ring/∧** or **vol/ring/∨** key or enter a number (**0 - 9**) to select the memory location to be stored.

```
5/17 12:30PM 03  
Movies  
800-730-3456
```

```
Select Location  
1▶  
2 JOHN DOE
```

note

- You cannot make a call from the Caller ID list if your cordless telephone is connected to a private branch exchange (PBX).
- When a long distance call has been set, "1" appears in the display.

note

You cannot store a Caller ID message if a phone number does not appear in the message.

#### 4) Press *select*.

You hear a confirmation tone and the number is stored in memory. The display returns to the Caller ID list.

```
5/17 12:30PM 03
Movies
800-297-1023
```



If a message has already been stored in the selected memory number location, a confirmation screen is displayed. Press the *vol/ring/^* key to select "Yes". Press *select* to overwrite. The display returns to the Caller ID list.

```
Replace Memory?
Yes
No
```

## The Integrated Answering Device

The cordless phone has a built-in answering system that answers and records incoming calls. You can also use your answering system to record a conversation, leave a voice memo message, or to announce a special outgoing message to callers when you're away from your phone.

## Features

- Digital Tapeless Recording
- 11 Minutes of Recording Time
- Call Screening
- Selectable Outgoing Messages
- Voice Prompts for Guidance  
(Bi-lingual Announcement Option)
- Time and Day Announcement
- Remote Message Retrieval
- Toll Saver
- Conversation Recording
- Voice Memo

Digital Tapeless Recording allows you to quickly review, save, or delete the messages you choose. You will never have to worry about a tape wearing out, jamming, or resetting improperly.

The Integrated Answering System is easy and convenient to use, but **please read** through all of the instructions carefully.

# Turning the Answering System On/Off

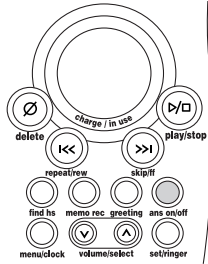

- 1) To turn the answering system on, press the **ans on/off** key. "Answering system is on" and the current greeting message will be played and you will hear a confirmation tone. The message counter displays the number of messages stored in memory. If the display flashes, then there are new messages waiting for you.
- 2) To turn the answering system off, press the **ans on/off** key again. After the announcement, "Answering system is off" the message counter display will no longer be illuminated.

# Setting up Your Answering System

## Using the Menu Mode

The Menu mode allows you to set the following Answering System functions.

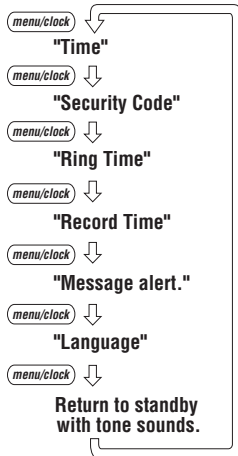

- To scroll through the menu options, repeatedly press the **menu/clock** key. The system returns to standby after the last menu option. You hear a confirmation tone to indicate standby mode.
- If any of the following occurs during menu setup, the operation is cancelled. Start over with the menu function prior to the interruption.
  - Press the **talk/flash** key
  - Press the **play/stop/▷◻** key
  - 10 second lapse of time
  - Receive a call
- The idle time default setting is 10 seconds. If the base remains idle for 10 seconds, an error tone sounds and the system returns to standby.



- For your convenience, voice prompts will guide you through the menu mode.
- After the setting, press the **play/stop/▷◻** key to exit the menu mode, or the **menu/clock** key to move to the next menu option. Or the system automatically returns to standby in 10 seconds after the setting.
- You have 5 seconds of idle time just after the 1st and last guidance of each menu setting.



- Normally the idle time for the menu mode is 10 seconds before the system returns to standby. However for setting the time, the idle time is extended to two minutes.
- Press and hold the **volume/select/∧** or **volume/select/∨** to quickly scroll through the numbers on the display.

## Setting the Time

The clock on the cordless phone's answering system starts when power is supplied to the base. Follow these steps to set the clock to the correct time.

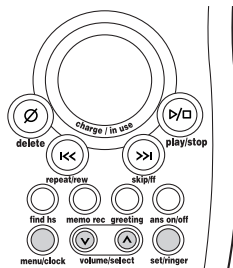

- 1) Press the **menu/clock** key.  
The system announces "Time", the current time and the guidance for setting the time.
- 2) Press the **volume/select/∧** or **volume/select/∨** key until the correct day is announced. The numbers [ 1 ] through [ 7 ] are displayed on the base.
- 3) Press the **set/ringer** key to select the day.
- 4) Press the **volume/select/∧** or **volume/select/∨** key until you hear the correct hour setting. The numbers [ 1 ] through [ 12 ] are displayed on the base as each hour is announced.
- 5) Press the **set/ringer** key to select the hour.
- 6) Press the **volume/select/∧** or **volume/select/∨** key until you hear the correct minute setting. The numbers [ 00 ] through [ 59 ] are displayed on the base as each minute is announced.
- 7) Press the **set/ringer** key to select the minute.
- 8) Press the **volume/select/∧** or **volume/select/∨** key until you hear the correct AM or PM setting.  
The message counter displays [ A ] or [ P ].
- 9) Press the **set/ringer** key to select the AM/PM setting.

You hear a confirmation tone, then the announcement "Time" and the time and day are announced for your review. After a few seconds, the system announces "To set security code, press menu again".



## Setting a Personal Security Code (PIN)

To play your messages from a remote location, you need to enter a two-digit Personal Identification Number (PIN) code (01-99). To select a PIN, perform the following steps:

- 1) Press the **menu/clock** key twice in standby mode.  
“Security code” and the current PIN code is announced as it is displayed on the base. Then the system announces the guidance for setting the PIN code.
- 2) Press the **volume/select/∧** or **volume/select/∨** key until the desired number appears.
- 3) Press the **set/ringer** key to select the PIN code. You hear a confirmation tone, then the announcement “Security code” and the new PIN code is announced. After a few seconds, the system announces “To set ring time, press menu again”.

## Setting the Ring Time

The ring time setting allows you to set the number of rings the caller hears before your answering system plays the outgoing message. You can set the ring time to answer after two, four, or six rings. Setting ୧5 (Toll Saver), the answering system picks up after two rings if you have new messages, and after four rings if there are none. This way, if you make a long distance call to check your messages, you can hang up after the second ring to avoid billing charges.

- 1) Press the **menu/clock** key three times in standby mode.  
You hear “Ring time” and the current ring time ([ ୨ ] 2, [ ୪ ] 4, [ ୬ ] 6, [ ୧5 ] Toll saver), and it is displayed on the base. Then you hear the guidance for setting the ring time.
- 2) Press the **volume/select/∧** or **volume/select/∨** key until the desired ring time appears.
- 3) Press the **set/ringer** key to select the new ring time. You hear a confirmation tone, then the announcement “Ring time” and the new ring time is announced. After a few seconds, the system announces “To set record time, press menu again”.



The PIN code is set to “80” when you purchase the cordless phone.



After setting the Announce only feature, you may want to change your outgoing message not to prompt the caller to leave a message. However, the prerecorded message changes automatically.

## Selecting the message Record Time

You have three record time options. The options “1 minute” or “4 minutes” set the duration for recording the incoming messages. “**Announce only**” answers the call with the preset greeting or your personal greeting but prevents the caller from leaving a message.

- 1) Press the **menu/clock** key four times in standby mode.  
You hear “Record time” and the current recording time ([ 1 ] 1 minute, [ 4 ] 4 minutes, [ R ] Announce only, No recording), and it is displayed on the base.  
Then you hear the guidance for setting the record time.
- 2) Press the **volume/select/^** or **volume/select/v** key until the desired time appears.
- 3) Press the **set/ringer** key to select the new recording time. You hear a confirmation tone, then the announcement “Record time” and the new recording time is announced. After a few seconds, the system announces “To set message alert, press menu again”.

### ▼Announce only feature

The announce only feature plays a prerecorded outgoing message “Hello, no one is available to take your call. Please call again.”, and it will not allow the caller to leave a message. To set “Announce only”, follow the steps above.

To scroll between the prerecorded message or your own personal greeting, press the **greeting** key when the outgoing message is played. If you want to use your own greeting, or want to omit the prompt “to leave a message from your greeting”.

Refer to “Recording a personal outgoing message” (Greeting) on page 36.

## Setting the Message Alert tone

Message Alert feature lets you know you have new messages by sounding a short beeping tone. If you set the Message Alert to On and when a new message is received, the alert tone will sound every 15 seconds.

- 1) Press the **menu/clock** key five times in standby mode.  
You hear “Message alert” and the current setting ([ OFF ] Off or [ ON ] On), and it is displayed on the base. Then you hear the guidance for setting the Message Alert.

- 2) Press the ***volume/select/∧*** or ***volume/select/∨*** key to make your selection.
- 3) Press the ***set/ringer*** key to select the new setting. You hear a confirmation tone, then the announcement "Message alert" and the current setting you have selected is announced. After a few seconds, the system announces "To set language, press menu again". When the first new message is received, the alert tone will begin to sound.

Turning the Message Alert tone Off by pressing any key.

- 1) To quickly turn Message Alert tone off, **press any key** on the base unit and the tone will **automatically deactivate**. To reset, go back into the menu setup mode (steps 1 - 3 above.)

Turning Message Alert tone Off when you're away from your phone.

- 1) When all **new messages** are played back using the remote playback feature (see page 41) the Message Alert tone will automatically deactivate. The tone will not deactivate until all messages are played back.

## Selecting the Language

The answering system voice announcements can be heard in English or French.

To choose the language of the answering system voice announcements:

- 1) Press the ***menu/clock*** key six times in standby mode.  
You hear the announcement "Language, English" followed by the guidance for setting the language. The current setting (" E " or " F ") appears on the base.
- 2) Press the ***volume/select/∧*** or ***volume/select/∨*** key to select the desired language.
- 3) Press the ***set/ringer*** key. A confirmation tone is heard along with the setting in the language selected.



- You can record a greeting up to 30 seconds long.
- Position yourself as near to the base as possible and speak clearly when recording your outgoing message.

## Setting Your Outgoing Message (Greeting)

When you receive a call, the answering system automatically plays either a preset message or your own greeting.

### ▼Preset message

The following message is prerecorded:

“Hello, no one is available to take your call. Please leave a message after the tone.”



See “Selecting the message Record Time”, page 34 on how to set the announce only feature.

### ▼Recording a personal outgoing message (Greeting)

1) Press and hold the ***greeting*** key.

You hear the announcement “Record greeting” and a confirmation tone.

[ - - ] flashes on the message counter.

2) Start recording your message. You have 30 seconds, and the message counter starts to count down [ 30 ] to [ 01 ] every second.

3) When you are finished recording your greeting, press the ***greeting, play/stop/▶◻*** or ***set/ringer*** key. You hear a confirmation tone, and then your greeting plays back for you.

### ▼Choosing between the two outgoing messages

Press the ***greeting*** key. Then press the ***greeting*** key again when the outgoing message is played. This switches between the prerecorded greeting and the personal greeting.

After finishing playing back the message, a confirmation tone is heard.



To delete the personal Greeting, press the ***delete/∅*** key during the announcement and the system announces “Greeting has been deleted”.

## Setting the base ringer volume

You have three ringer options. One allows you to turn the ringer off. The other two are volume levels.

1) Press the **set/ringer** key.

You hear the ringer at the current volume level ([ *H* ] High, [ *L* ] Low, [ *OFF* ] off) (if you set the base ringer volume to off, "Ringer off" is announced) and it is displayed on the base.

2) Press the **set/ringer** key until the desired ringer option appears.

3) The system displays the new ringer volume.

## Temporarily Mute the Base Ringer

Press the **play/stop/** key to temporarily mute the incoming ring. The ringer will sound with the next incoming call.

## Adjusting the speaker volume level

You can adjust the volume of the base speaker by pressing the **volume/select/** key or **volume/select/** key on the base. Press **volume/select/** for louder or **volume/select/** for softer while the base speaker is being used except for menu mode. The numbers 0 - 9 are displayed on the base indicating the volume levels. 0 being the softest and 9 being the loudest.



When you have set the base ringer to off and the handset is on the base, you will still hear the ringer from the handset.



When you press **volume/select/** key at 9 or the **volume/select/** key at 0, an error tone sounds.

# Using Your Answering System

The message counter displays the number of messages stored in memory. If the display flashes, then there are new messages waiting for you. The flashing number represents the number of new messages, not total messages. The cordless phone is designed to play your new messages first. After you play all your new messages, you can then play your old messages.



When the answering system is full, *FL* is displayed on the base, and the system announces “No remaining time”. You should delete some messages so that the system can record new messages. (Refer to “Deleting a message” on page 40.)

## Playing your messages

- 1) Press the ***play/stop***/ $\blacktriangleright$  key.

The system announces the number of new and old messages. The LED displays the number of new messages, and the number flashes. The day and time that each message was received is announced after the message is played. The message counter displays the number of current messages stored.

When all new messages have been played, you hear a confirmation tone and an announcement “End of messages”. The system returns to standby.

- 2) After you have reviewed your new messages, you can play your old messages by again pressing the ***play/stop***/ $\blacktriangleright$  key. Once you have listened to a new message, it becomes an old message. The old messages will be played in the order in which they were received.



To stop playing your messages, press the ***play/stop***/ $\blacktriangleright$  key again at any time.

## Repeating a message

- 1) Press the **play/stop/▶** key to review your messages. The number of stored messages is announced.
- 2) After a message has played for a few seconds, press the **repeat/rew/◀** key to replay the message. If you have several messages, press the **repeat/rew/◀** key repeatedly until you return to the message you want to replay.
- 3) Press the **play/stop/▶** key at any time to stop reviewing messages and return to standby. The message counter shows the number of messages stored in memory.

*To quickly scroll backward through a message, press and hold the **repeat/rew/◀** key.*

## Skipping a message

- 1) Press the **play/stop/▶** key to review your messages. The number of messages is announced.
- 2) Press the **skip/ff/▶▶** key at anytime to skip to the next message. Each time the **skip/ff/▶▶** key is pressed, the system scans forward one message. If you have several messages, press the **skip/ff/▶▶** key repeatedly to find the message you want to play.
- 3) Press the **play/stop/▶** key at any time to stop reviewing your messages and return to standby. The message counter shows the number of messages stored in memory.

*To quickly scroll forward through a message, press and hold the **skip/ff/▶▶** key.*



When you press the **delete/∅** key, you are permanently deleting the message. Once deleted, the message cannot be replayed.



- The voice memo function is completely independent of the greeting message.
- The voice memo messages are recorded as incoming messages

## Deleting a message

To maintain maximum record time, delete the old messages.

- 1) Press the **play/stop/▶◻** key to review your messages.
- 2) Press the **delete/∅** key anytime during the message to delete.
- 3) You hear a confirmation tone and the message is deleted.

You can also delete all the messages.

- 1) Press the **delete/∅** key in standby mode.  
You hear an announcement "To delete all messages, press delete again".
- 2) Press the **delete/∅** key again.  
You hear a confirmation tone and 0 is displayed on the base. All the messages are deleted.

When you try to delete all messages without first listening to your new messages, you hear several short beeps followed by an announcement "Please playback all messages". This protects you from accidentally erasing messages you have not yet reviewed.

## Voice memo

The voice memo function allows you to record messages (up to 4 minutes).

- 1) Press and hold the **memo rec** key.  
You hear an announcement "Record memo message" and a tone. [ -- ] flashes on the message counter.
- 2) Start your recording.
- 3) When you have finished, press the **play/stop/▶◻**, **memo rec** or **set/ringer** key to stop recording. You hear a confirmation tone and the system returns to standby.



## Recording a conversation

You can record up to 10 minutes of conversation while you are using your phone.

- 1) During a conversation from the handset, press and hold the **memo rec** key. The unit begins recording with a confirmation tone and [ - - ] flashes on the message counter.

**A beep that can be heard by both parties, sounds during recording.**

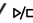

If you receive a call waiting tone while recording a conversation, press the **talk/flash** to accept the waiting call. The recording feature continues recording the new call. The original call is put on hold.

- 2) To stop recording, press the **play/stop/**  or **memo rec** key. You hear a confirmation tone.

## Remote access away from home

You can operate your answering system from a remote location using any touch-tone telephone. Use this function to check for recorded messages, to play or delete messages, even to record a new greeting message.

- 1) Call your telephone number.
- 2) During the greeting message, press the **0** key and enter your PIN code. (See "Setting a Personal Security Code", page 33).
- 3) The answering system announces the current time and the number of messages stored in memory. Then you hear "To play incoming messages, press zero two. For help, press one zero".
- 4) You may continue to listen to the Help Guidance, or you may select a command from the following chart:



- A recorded conversation is treated as a typical message and will be added to the stored messages.
- When recording a conversation, all dialing features except for flash operation (see page 17) is disabled. Stop recording if you need to enable any other handset keys.



For your convenience remote operation cards are provided for you to use while away from home (located backward of this manual).



- You must enter a command within 15 seconds of entering command waiting mode or the answering system automatically hangs up and returns to standby.
- The system will only playback messages for four minutes and then it returns to command waiting mode. To continue playing your messages, press # then 2 again within 15 seconds.

<b>Command</b>	<b>Function</b>
<b>0 then 1</b>	Repeat a Message
<b>0 then 2</b>	Playing Incoming Messages
<b>0 then 3</b>	Skipping a Message
<b>0 then 4</b>	Deleting a Message
<b>0 then 5</b>	Stop Operation
<b>0 then 6</b>	Answering System On
<b>0 then 7</b>	Memo Record/Stop*
<b>0 then 8</b>	Greeting Message Record/Stop*
<b>0 then 9</b>	Answer System Off
<b>1 then 0</b>	Help Guidance

- \* For Memo Record and Greeting Message Record function, the first time you enter the corresponding command, it starts the Recording function. If you want to stop the recording, enter the command again.
- 5) After all of the Help Guidance prompts have played, you hear intermittent beeps indicating that the system is in the command waiting mode. You may enter another command at this time from the chart.
  - 6) When you are finished, hang up to exit the system. The answering system automatically returns to standby.



- To protect you against misbilled calls which might result from your phone being activated by other equipment, the phone has **AutoSecure™** feature electronically locks your phone when the handset is on the base. Also, the **Random Code™** digital security which automatically selects one of over 262,000 digital security codes for the handset and base.
- If the handset battery pack is completely discharged or the battery pack is removed, the digital security code will be lost. If this happens, a new security code is set automatically the next time the battery pack is charged.

## Turn on the answering system remotely

If you have forgotten to turn on your answering system, you can turn it on remotely from any touch-tone telephone.

- 1) Call your telephone number.
- 2) Wait ten rings until the system answers. You hear a beep.
- 3) Press **0** and then enter your PIN code. The answering system announces the current time and the number of messages stored in memory. You hear "To play incoming messages, press zero two. For help, press one zero".
- 4) Press **0** then **6** to turn the answering system On. You hear the outgoing message and a confirmation tone.
- 5) Hang up the phone and subsequent calls will be answered by the system.

## Changing the Digital Security Code

The digital security code is an identification code used to connect the handset and the base unit. Normally, setting the code is not necessary. The first time you charge your handset, the security code is automatically set.

In the rare situation that you suspect another cordless telephone is using the same security code, you can change the code.

- 1) Remove the handset from the base unit. Press and hold the **find hs** key on the base.
- 2) While holding the **find hs** key, place the handset on the base unit, and leave the handset on the base for more than 3 seconds. A new random security code is set.

## Installing the Beltclip

### To attach the beltclip

Insert the beltclip into the holes on each side of the handset. Press down until it clicks.

### To remove the beltclip

Pull both sides of the beltclip to release the tabs from the holes.

# Headset Installation

Your phone may be used with an optional headset, the Uniden HS910. To use this feature, insert headset plug into the headset jack. Your phone is ready for hands-free conversations. (Headset may be purchased by calling the Uniden Parts Department or visiting the web site. See Quick Reference Guide on page 3.)

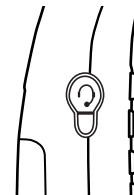

## Note on Power Sources

### Battery replacement and handling

When the operating time becomes short, even after a battery is recharged, please replace the battery. With normal usage, your battery should last about one year. Please contact your place of purchase or the Uniden Parts Department for a replacement battery.

**Warning:** To avoid the risk of personal injury or property damage from fire or electrical shock, only use the Uniden battery model and Uniden adapter model specifically designated for this product.

#### Power Failure

During the period that the power is off, you will not be able to make or receive calls with the telephone.

#### Caution

- Use only the specified Uniden battery pack (BT-905).
- Do not remove the battery from the handset to charge it.
- Never throw the battery into a fire, disassemble it, or heat it.
- Do not remove or damage the battery casing.

## Maintenance

### When the handset or base unit becomes slightly dirty

Wipe with a soft, dry cloth.

### When the handset or base unit becomes very dirty

Wipe with a soft cloth that has been dampened with diluted, neutral detergent. Dry with a dry cloth.

### When the charging contacts become very dirty on both the handset and base unit

Using water only, dampen a cloth to clean the charging contacts. Then make sure to go back over the charging contacts with a dry cloth before returning the handset to the base unit to charge.

#### Caution

Do not use paint thinner, benzene, alcohol, or other chemical products. Doing so may discolor the surface of the telephone and damage the finish.

# Troubleshooting

If your phone is not performing to your expectations, please try these simple steps first.

Symptom	Suggestion
The <b>charge/in use</b> LED won't illuminate when the handset is placed on the base.	<ul style="list-style-type: none"> <li>• Make sure the AC adapter is plugged into the base and wall outlet.</li> <li>• Make sure the handset is properly seated on the base.</li> <li>• Make sure the charging contacts on the handset and base are clean.</li> </ul>
The audio sounds weak and/or scratchy.	<ul style="list-style-type: none"> <li>• Make sure that the base antenna is in a vertical position.</li> <li>• Move the handset and/or base to a different location away from metal objects or appliances and try again.</li> <li>• Press <b><i>delete/channel</i></b> in the Talk mode to help eliminate background noise.</li> <li>• Make sure that the handset is not too far from the base.</li> </ul>
Can't make or receive calls.	<ul style="list-style-type: none"> <li>• Check both ends of the telephone line cord.</li> <li>• Make sure the AC adapter is plugged into the base and wall outlet.</li> <li>• Disconnect the AC adapter for a few minutes, then reconnect it.</li> <li>• Change the digital security code (See page 43).</li> <li>• Make sure that the handset is not too far from the base.</li> </ul>
The handset doesn't ring or receive a page.	<ul style="list-style-type: none"> <li>• The battery pack may be weak. Charge the battery for 15-20 hours.</li> <li>• The handset may be too far from the base unit.</li> <li>• Place the base unit away from appliances or metal objects.</li> <li>• Change the digital security code (See page 43).</li> </ul>
Severe noise interference.	<ul style="list-style-type: none"> <li>• Keep the handset away from microwave ovens, computers, remote control toys, wireless microphones, alarm systems, intercoms, room monitors, fluorescent lights, and electrical appliances.</li> <li>• Move to another location or turn off the source of interference.</li> </ul>

<b>Symptom</b>	<b>Suggestion</b>
The Caller ID does not display.	<ul style="list-style-type: none"> <li>• The handset was picked up before the second ring.</li> <li>• The call was placed through a switchboard.</li> <li>• Call your local telephone company to verify your Caller ID service is current.</li> </ul>
The answering system does not work.	<ul style="list-style-type: none"> <li>• Make sure the base unit is plugged in.</li> <li>• Make sure the answering system is turned on.</li> </ul>
Cannot record any messages.	<ul style="list-style-type: none"> <li>• Set the record time to either the one minute or four minute option.</li> <li>• The memory may be full. Delete some or all of the saved messages.</li> </ul>
Messages are incomplete.	<ul style="list-style-type: none"> <li>• The incoming messages may be too long. Remind callers to leave a brief message.</li> <li>• The memory may be full. Delete some or all of the saved messages.</li> </ul>
After a power failure, the outgoing message is deleted.	<ul style="list-style-type: none"> <li>• Record your personal outgoing message again. The default message should remain.</li> </ul>
No sound on the base unit speaker during call monitoring or message playback.	<ul style="list-style-type: none"> <li>• Adjust the speaker volume on the base unit.</li> </ul>
Cannot access remote call-in features from another touch-tone phone.	<ul style="list-style-type: none"> <li>• Make sure you're using the correct PIN code.</li> <li>• Make sure that the touch-tone phone you're using can transmit the tone for at least two seconds. If it cannot, you may have to use another phone to access your messages.</li> </ul>
If you still have a problem.	<ul style="list-style-type: none"> <li>• Call our customer hotline at 1-800-297-1023.</li> </ul>

## Liquid Damage

Moisture and liquid can damage your cordless phone. In case of accidental submersion, please read the following steps.

Case	Action
<p>If the handset or base is exposed to moisture or liquid, but only affects the exterior plastic housing.</p>	<p>Wipe off the liquid and use as normal.</p>
<p>If moisture or liquid has entered the plastic-housing (i.e. liquid can be heard in the phone or liquid has entered the handset battery compartment or vent openings on the base).</p>	<p>Handset:</p> <ol style="list-style-type: none"> <li>1. Remove the battery cover and leave it off for ventilation.</li> <li>2. Remove the battery pack by disconnecting.</li> <li>3. Leave the battery cover off and the battery pack disconnected for at least 3 days.</li> <li>4. Once completely dry, reconnect the battery pack and the battery cover.</li> <li>5. Recharge the handset's battery pack for 20 hours on the base unit before using the phone.</li> </ol> <p>Base:</p> <ol style="list-style-type: none"> <li>1. Disconnect the AC adapter from the base unit, cutting off electrical power.</li> <li>2. Disconnect the telephone cord from the base unit.</li> <li>3. Let dry for at least 3 days.</li> </ol> <p><b>IMPORTANT:</b> You must <b>unplug the telephone line while recharging the battery pack</b> to avoid charge interruption.</p> <p><b>CAUTION:</b> DO NOT use a microwave oven to speed up the drying process. This will cause permanent damage to the handset, base and the microwave oven.</p> <p>After following these steps, if your cordless telephone does not work, please send to: Uniden America Corporation Parts and Service Division 4700 Amon Carter Blvd. Ft. Worth, TX 76155 1-800-554-3988. Monday through Friday 8 a.m. to 5 p.m. CST</p>

# General Information

The phone complies with FCC Parts 15 and 68.

Operating temperature: -10° to 50°C (+14°F to +122°F)

## AC Adapter Information

AC Adapter part number:	AD-314
Input Voltage:	120V AC 60Hz
Output Voltage:	9V AC 350 mA

## Battery Information

Battery part number:	BT-905
Capacity:	600 mAH, 3.6V
Battery use time (per charge) From fully charged	
Talk mode duration:	Up to 7 hours
Standby mode duration:	Up to 14 days



- To avoid damage to the phone use only Uniden AD-314 and BT-905 with your phone.
- If the handset is left off of the base, the actual Talk mode duration will be reduced respective to the amount of time the handset is off the base.

Recharge your phone on a regular basis by returning the handset to the base after each phone call. When the operating time becomes short, even after the battery is recharged, please replace the battery. With normal usage, the battery should last about one year.

A replacement Uniden adapter and battery may be purchased at your local Uniden dealer or by contacting the Uniden Parts Department (800) 554-3988. Hours are from 8:00 a.m. to 5:00 p.m. Central Time, Monday through Friday. We can also be reached on the web at [www.uniden.com](http://www.uniden.com).

Specifications, features, and availability of optional accessories are all subject to change without prior notice.



## Precautions!

Before you read anything else, please observe the following:

### Warning!

Uniden America Corporation DOES NOT represent this unit to be waterproof. To reduce the risk of fire, electrical shock, or damage to the unit, DO NOT expose this unit to rain or moisture.

### Rechargeable Nickel-Cadmium Battery Warning

- This equipment contains a rechargeable nickel-cadmium battery.
- Cadmium is a chemical known to the State of California to cause cancer.
- The rechargeable nickel-cadmium battery contained in this equipment may explode if disposed of in a fire.
- **Do not** short-circuit the battery.
- Do not charge the rechargeable nickel-cadmium battery used in this equipment in any charger other than the one designed to charge this battery as specified in the owner's manual. Using another charger may damage the battery or cause the battery to explode.



### Rechargeable Nickel-Cadmium Batteries Must Be Recycled or Disposed of Properly

- Uniden voluntarily participates in an RBRC® industry program to collect and recycle nickel-cadmium batteries at the end of their useful life, when taken out of service within the United States. The RBRC® program provides a convenient alternative to placing used nickel-cadmium batteries into the trash or municipal waste stream, which is illegal in some areas.
- Through the RBRC® program, Uniden makes it easy for you to drop off the used battery at local retailers of replacement nickel-cadmium batteries. You may also contact your local recycling center for information on where to return the used battery. Please call 1-800-8-BATTERY for information on Ni-Cd battery recycling in your area. Uniden's involvement in this program is part of its commitment to protecting our environment and conserving natural resources.
- RBRC® is a registered trademark of the Rechargeable Battery Recycling Corporation.

The exclamation point within an equilateral triangle is intended to alert the user to the presence of important operating and maintenance (servicing) instructions in the literature accompanying the appliance.

Uniden works to reduce lead content in our PVC coated cords in our product and accessories.

### WARNING!

The cords on this products and/or accessories contain lead, a chemical known to the State of California to cause birth defects or other reproductive harm. **Wash hands after handling.**

## Important Safety Instructions

When using your telephone equipment, these basic safety precautions should always be followed to reduce the risk of fire, electrical shock, and injury to persons:

1. Read and understand all instructions.
2. Follow all warnings and instructions marked on the product.
3. Unplug this product from the wall outlet before cleaning. Use a dry cloth for cleaning without liquid or aerosol cleaners.
4. Do not use this product near water; for example, near a bathtub, wash bowl, kitchen sink or laundry tub, in a wet basement, or near a swimming pool.
5. Do not place this product on an unstable cart, stand, or table. The telephone may fall, causing serious damage to the unit.
6. Slots and openings in the cabinet and the back or bottom are provided for ventilation. To protect the product from overheating, these openings must not be blocked or covered. This product should never be placed near or over a radiator or heat register. This product should not be placed in a built-in installation unless proper ventilation is provided.
7. This product should be operated only from the type of power source indicated on the marking label. If you are not sure of the type of power supply to your home, consult your dealer or local power company.
8. Do not allow anything to rest on the power cord. Do not locate this product where the cord will be damaged by persons walking on it.
9. Do not overload wall outlets and extension cords, as this can result in the risk of fire or electrical shock.
10. Never push objects of any kind into this product through cabinet slots, as they may touch dangerous voltage points or short out parts that could result in a risk of fire or electric shock. Never spill liquid of any kind on the product.
11. To reduce the risk of electric shock, do not disassemble this product. Take it to qualified service personnel when service or repair work is required. Opening or removing covers may expose you to dangerous voltages or other risks. Incorrect reassembly can cause electric shock when the appliance is subsequently used.
12. Unplug this product from the wall outlet and refer servicing to qualified service personnel under the following conditions:
  - A. When the power supply cord is damaged or frayed.
  - B. If liquid has been spilled into the product.
  - C. If the product has been exposed to rain or water.
  - D. If the product does not operate normally when following the operating instructions. (Adjust only those controls that are covered by the operating instructions. Improper adjustment of other controls may result in damage and will often require extensive repair work by a qualified technician.)
  - E. If the product has been dropped or the cabinet has been damaged.
  - F. If the product exhibits a distinct change in performance.
13. Do not use the telephone to report a gas leak in the vicinity of the leak.

### Additional Battery Safety Precautions

**Caution!** To reduce the risk of fire or injury to persons by the

battery, read and follow these instructions:

1. Use only the Uniden battery pack specified in the owner's manual.
2. Do not dispose of the battery pack in a fire. The cell may explode. Check the nickel-cadmium battery disposal package insert for disposal instructions.
3. Do not open or mutilate the battery pack. Released electrolyte is corrosive and may cause damage to the eyes or skin. It may be toxic if swallowed.
4. Exercise care in handling the battery in order not to short the battery with conducting materials such as rings, bracelets, and keys. The battery or conductor may overheat and cause burns.
5. Charge the battery pack provided with or identified for use with this product only in accordance with the instructions and limitations specified in the owner's manual provided for this product.
6. Observe proper polarity orientation between the battery pack and battery charger.

### SAVE THESE INSTRUCTIONS!

## Important Electrical Considerations

Unplug all electrical appliances when you know an electrical storm is approaching. Lightning can pass through your household wiring and damage any device connected to it. This phone is no exception.

### The FCC Wants You To Know

Changes or modifications to this product not expressly approved by Uniden, or operation of this product in any way other than as detailed by the owner's manual, could void your authority to operate this product. Your telephone complies with Part 68 of FCC Rules. You must, upon request, provide the FCC registration number and the REN to your telephone company. Both numbers are on the base unit.

- NOTE:**
- You must not connect your phone to:
    - coin-operated systems
    - most electronic key telephone systems

### Range

Your new phone is designed to achieve the maximum possible range by transmitting and receiving according to the highest specifications set forth by the FCC. We have rated this phone to operate at a maximum distance with the qualification that the range depends upon the environment in which the telephone is used. Many factors limit range, and it would be impossible to include all the variables in our rating. The Maximum Range rating of this phone is meant to be used as a means of comparison against other range claims.

### Telephone Line Problems

The FCC has granted the telephone company the right to disconnect service in the event that your phone causes problems on the telephone line. Also, the telephone company may make changes in facilities and services which may affect the operation of your unit. However, your telephone company must give adequate notice in writing prior to such actions to allow you time for making necessary arrangements to continue uninterrupted service. If you are having trouble with your telephone service, you must first disconnect your phone to determine if it is the cause of your problem. If you determine that it is the cause, you must leave it disconnected until the trouble has been corrected.

## Telephone Line Problems

The FCC has granted the telephone company the right to disconnect service in the event that your phone causes problems on the telephone line. Also, the telephone company may make changes in facilities and services which may affect the operation of your unit. However, your telephone company must give adequate notice in writing prior to such actions to allow you time for making necessary arrangements to continue uninterrupted service.

If you are having trouble with your telephone service, you must first disconnect your phone to determine if it is the cause of your problem. If you determine that it is the cause, you must leave it disconnected until the trouble has been corrected.

## Radio Interference

Radio interference may occasionally cause buzzing and humming in your cordless handset, or clicking noises in the base. This interference is caused by external sources such as TV, refrigerator, vacuum cleaner, fluorescent lighting, or electrical storm. Your unit is NOT DEFECTIVE.

If these noises continue and are too distracting, please check around your home to see what appliances may be causing the problem. In addition, we recommend that the base not be plugged into a circuit that also powers a major appliance because of the potential for interference. Be certain that antenna on the unit is fully extended.

In the unlikely event that you consistently hear other voices or distracting transmissions on your phone, you may be receiving radio signals from another cordless telephone or other source of interference. If you cannot eliminate this type of interference, you need to change to a different channel.

Finally, it should be noted that some cordless telephones operate at frequencies that may cause interference to nearby TVs and VCRs.

To minimize or prevent such interference, the base of the cordless telephone should not be placed near or on top of a TV or VCR.

If interference is experienced, moving the cordless telephone farther away from the TV or VCR will often reduce or eliminate the interference.

## More Than One Cordless Telephone

If you want to use more than one cordless telephone in your home, they must operate on different channels. Press the channel key to select a channel that provides the clearest communication.

## Cordless Telephone Privacy

Cordless telephones are radio devices. Communications between the handset and base of your cordless telephone are accomplished by means of radio waves which are broadcast over the open airways. Because of the inherent physical properties of radio waves, your communications can be received by radio receiving devices other than your own cordless telephone unit. Consequently, any communications using your cordless telephone may not be private.

## Installation Considerations

### Selecting a Location

Before choosing a location for your new phone, there are some important guidelines you should consider:

- The location should be close to both a phone jack and continuous power outlet. (A continuous power outlet is an AC outlet which does not have a switch to interrupt its power.)
- Keep the base and handset away from sources of electrical noise such as motors or fluorescent lighting.
- Be sure there is sufficient space to fully extend the base antenna.
- The base can be placed on a desk or tabletop or mounted on a standard telephone wall plate.
- You should charge your new phone for 15-20 hours before completing the installation or using the handset.

## Telephone Line Outlets

There are two types of phone outlets:

### Modular Jack

Most phone equipment available now uses modular jacks. Phone cords are fitted with a molded plastic connector which plugs into this type of jack. If you do not have modular phone jacks, contact your local telephone company for information about their installation.

### Hardwired Jack

Some equipment is wired directly to a phone jack, and these types of installations require a modular jack converter. This type of installation is not difficult; however, you should contact your Uniden telephone dealer or a telephone supply store for advice about the proper adapter or converter for your particular situation.

## Connecting the Telephone Cords

Consider these safety guidelines before connecting the telephone cords:

### Caution!

- *Never install telephone wiring during a lightning storm.*
- *Never touch uninsulated telephone wires or terminals unless the telephone line has been disconnected.*
- *Use caution when installing or modifying telephone lines.*

## Applying Power to the Base

This phone requires an AC outlet, without a switch to interrupt power, and the included AC adapter. To relieve strain on the DC plug when the phone is placed on a desk or table, wrap the power cord around the strain relief notch on the back of the base.

*NOTE: Place the power cord so that it does not create a trip hazard, or where it could become chafed and create a fire or other electrical hazards.*

## One Year Limited Warranty

**Important:** Evidence of original purchase is required for warranty service.

**WARRANTOR:** UNIDEN AMERICA CORPORATION ("Uniden")

**ELEMENTS OF WARRANTY:** Uniden warrants, for one year, to the original retail owner, this Uniden Product to be free from defects in materials and craftsmanship with only the limitations or exclusions set out below.

**WARRANTY DURATION:** This warranty to the original user shall terminate and be of no further effect 12 months after the date of original retail sale. The warranty is invalid if the Product is (A) damaged or not maintained as reasonable or necessary, (B) modified, altered, or used as part of any conversion kits, subassemblies, or any configurations not sold by Uniden, (C) improperly installed, (D) serviced or repaired by someone other than an authorized Uniden service center for a defect or malfunction covered by this warranty, (E) used in any conjunction with equipment or parts or as part of any system not manufactured by Uniden, or (F) installed or programmed by anyone other than as detailed by the owner's manual for this product.

**STATEMENT OF REMEDY:** In the event that the product does not conform to this warranty at any time while this warranty is in effect, warrantor will either, at its option, repair or replace the defective unit and return it to you without charge for parts, service, or any other cost (except shipping and handling) incurred by warrantor or its representatives in connection with the performance of this warranty. Warrantor, at its option, may replace the unit with a new or refurbished unit. THE LIMITED WARRANTY SET FORTH ABOVE IS THE SOLE AND ENTIRE WARRANTY PERTAINING TO THE PRODUCT AND IS IN LIEU OF AND EXCLUDES ALL OTHER WARRANTIES OF ANY NATURE WHATSOEVER, WHETHER EXPRESS, IMPLIED OR ARISING BY OPERATION OF LAW, INCLUDING, BUT NOT LIMITED TO ANY IMPLIED WARRANTIES OF MERCHANTABILITY OR FITNESS FOR A PARTICULAR PURPOSE. THIS WARRANTY DOES NOT COVER OR PROVIDE FOR THE REIMBURSEMENT OR PAYMENT OF INCIDENTAL OR CONSEQUENTIAL DAMAGES. Some states do not allow this exclusion or limitation of incidental or consequential damages so the above limitation or exclusion may not apply to you.

**LEGAL REMEDIES:** This warranty gives you specific legal rights, and you may also have other rights which vary from state to state. This warranty is void outside the United States of America and Canada.

**PROCEDURE FOR OBTAINING PERFORMANCE OF WARRANTY:** If, after following the instructions in the owner's manual you are certain that the Product is defective, pack the Product carefully (preferably in its original packaging). The Product should include all parts and accessories originally packaged with the Product. Include evidence of original purchase and a note describing the defect that has caused you to return it. The Product should be shipped freight prepaid, by traceable means, to warrantor at:

### Uniden America Corporation

Parts and Service Division

4700 Amon Carter Blvd. Fort Worth, TX 76155

# I.C. Notice

## TERMINAL EQUIPMENT

**NOTICE:** This equipment meets the applicable Industry Canada Terminal Equipment Technical Specifications. This is confirmed by the registration number. The abbreviation, IC, before the registration number signifies that registration was performed based on a Declaration of Conformity indicating that Industry Canada technical specifications were met. It does not imply that Industry Canada approved the equipment.

**NOTICE:** The Ringer Equivalence Number (REN) for this terminal equipment is marked on the equipment itself. The REN assigned to each terminal equipment provides an indication of the maximum number of terminals allowed to be connected to a telephone interface. The termination on an interface may consist of any combination of devices subject only to the requirement that the sum of the Ringer Equivalence Numbers of all the devices does not exceed five.

## RADIO EQUIPMENT

The term "IC:" before the radio certification number only signifies that Industry Canada technical specifications were met.

Operation is subject to the following two conditions: (1) this device may not cause interference, and (2) this device must accept any interference, including interference that may cause undesired operation of the device. "Privacy of communications may not be ensured when using this telephone".

# Index

- A**
  - AC adapter information .....48
  - Announce only feature.....34
  - Answering system
    - Deleting a message .....40
    - Playing your messages .....38
    - Recording a conversation .....41
    - Remote access .....41
    - Repeating a message .....39
    - Skipping a message .....39
    - Turning on/off .....31
- B**
  - Base location .....8
  - Battery pack
    - Information .....48
    - Installing .....9
    - Preparing and charging .....10
    - Replacement and handling .....44
  - Beltclip installation .....43
- C**
  - Caller ID
    - Caller ID service .....26
    - Call Waiting .....17
    - Deleting .....27
    - Setting Caller ID options .....13
    - Using .....29
    - Viewing.....27
  - Call Waiting.....17
  - Chain dialing .....22
  - Channel .....17
  - Charging the battery pack .....10
  - Cleaning charging contacts.....10
- Clock .....32
- Connect the base unit .....11
- Controls and functions .....6
- D**
  - Dialing mode .....14
  - Digital security code .....43
- E, F, G, H, I, J, K, L**
  - Earpiece volume .....16
  - Flash .....17
  - General information .....48
  - Greeting .....36
  - Headset installation .....44
  - I.C. Notice .....51
  - Interference .....17
  - Liquid damage .....47
- M, N, O, P, Q**
  - Maintenance .....44
  - Making a call.....15
  - Memory dialing
    - Editing a stored name and phone number.....23
    - Erasing a stored name and phone number.....24
    - Making calls with memory dialing..21
    - Storing phone numbers and names 18
  - Menu mode .....31
  - Message alert.....34
  - Outgoing message.....36
  - Package contents .....3
  - Page .....17
  - Personal security code (PIN code) ....33
  - Precautions .....49
- Quick reference guide .....3
- R**
  - Receiving a call .....15
  - Recording time.....34
  - Redial .....16
  - Remote access .....41
  - Repeating .....39
  - Ringer volume
    - Base.....37
    - Handset .....16
  - Ring time .....33
  - RocketDial.....24
- S**
  - Setting menu options .....13
  - Setting up the phone .....8
  - Storing phone numbers and names ....18
- T, U**
  - Tone .....16
  - Traveling out-of-range .....17
  - Troubleshooting .....45
- V, W, X, Y, Z**
  - Voice memo.....40
  - Volume control.....16
  - Wall mounting .....12
  - Warranty .....50

# Remote Operation Card

C U T

## REMOTE OPERATION CARD

**Uniden**  
EXAI398 series

### Remote access away from home

1. Call your phone number from a touch-tone phone.
2. During the outgoing message, press 0 and enter your PIN code. The answering system announces the number of messages stored in memory and the help guidance. The phone stands by for you to enter a command.
3. To quit, hang up the phone.

### Turn on the answering system remotely

1. Call your phone and let it ring 10 times until it answers.
2. Press 0 and enter your PIN code.
3. Press 0 then 5 to stop the announcement.
4. Press 0 then 6 to turn the answering system on.

C U T

## REMOTE OPERATION CARD

**Uniden**  
EXAI398 series

### Remote access away from home

1. Call your phone number from a touch-tone phone.
2. During the outgoing message, press 0 and enter your PIN code. The answering system announces the number of messages stored in memory and the help guidance. The phone stands by for you to enter a command.
3. To quit, hang up the phone.

### Turn on the answering system remotely

1. Call your phone and let it ring 10 times until it answers.
2. Press 0 and enter your PIN code.
3. Press 0 then 5 to stop the announcement.
4. Press 0 then 6 to turn the answering system on.

C U T

## REMOTE OPERATION CARD

**Uniden**  
EXAI398 series

### Remote access away from home

1. Call your phone number from a touch-tone phone.
2. During the outgoing message, press 0 and enter your PIN code. The answering system announces the number of messages stored in memory and the help guidance. The phone stands by for you to enter a command.
3. To quit, hang up the phone.

### Turn on the answering system remotely

1. Call your phone and let it ring 10 times until it answers.
2. Press 0 and enter your PIN code.
3. Press 0 then 5 to stop the announcement.
4. Press 0 then 6 to turn the answering system on.

C U T

## REMOTE OPERATION CARD

**Uniden**  
EXAI398 series

### Remote access away from home

1. Call your phone number from a touch-tone phone.
2. During the outgoing message, press 0 and enter your PIN code. The answering system announces the number of messages stored in memory and the help guidance. The phone stands by for you to enter a command.
3. To quit, hang up the phone.

### Turn on the answering system remotely

1. Call your phone and let it ring 10 times until it answers.
2. Press 0 and enter your PIN code.
3. Press 0 then 5 to stop the announcement.
4. Press 0 then 6 to turn the answering system on.

# Remote Operation Card

C U T

Task	Key
Repeat a Message	0 1
Playing Incoming Messages	0 2
Skipping a Message	0 3
Deleting a Message	0 4
Stop Operation	0 5
Answering System On	0 6
Memo Record/Stop	0 7
Greeting Message Record/Stop	0 8
Answer System Off	0 9
Help Guidance	1 0

C U T

Task	Key
Repeat a Message	0 1
Playing Incoming Messages	0 2
Skipping a Message	0 3
Deleting a Message	0 4
Stop Operation	0 5
Answering System On	0 6
Memo Record/Stop	0 7
Greeting Message Record/Stop	0 8
Answer System Off	0 9
Help Guidance	1 0

C U T

Task	Key
Repeat a Message	0 1
Playing Incoming Messages	0 2
Skipping a Message	0 3
Deleting a Message	0 4
Stop Operation	0 5
Answering System On	0 6
Memo Record/Stop	0 7
Greeting Message Record/Stop	0 8
Answer System Off	0 9
Help Guidance	1 0

C U T

Task	Key
Repeat a Message	0 1
Playing Incoming Messages	0 2
Skipping a Message	0 3
Deleting a Message	0 4
Stop Operation	0 5
Answering System On	0 6
Memo Record/Stop	0 7
Greeting Message Record/Stop	0 8
Answer System Off	0 9
Help Guidance	1 0

## **At Uniden, we'll take care of you!**

If you need any assistance with this product, please call our Customer Hotline at

**1-800-297-1023**

**PLEASE DO NOT RETURN THIS PRODUCT TO THE PLACE OF PURCHASE.**

Our Uniden representatives will be happy to help you with any matters regarding the operation of this unit, available accessories, or any other related matters.

Thank you for purchasing a Uniden product.  
Hours: M-F 8:00 AM to 5:00 PM CST.



For information on the accessibility features of this product, please call

**1-800-874-9314 (V/TTY)**

# Uniden®

May be covered under one or more of the following U.S. patents:

4,523,058	4,595,795	4,797,916	5,381,460	5,426,690	5,434,905
5,491,745	5,493,605	5,533,010	5,574,727	5,581,598	5,650,790
5,660,269	5,661,780	5,663,981	5,671,248	5,696,471	5,717,312
5,732,355	5,754,407	5,758,289	5,768,345	5,787,356	5,794,152
5,801,466	5,825,161	5,864,619	5,893,034	5,912,968	5,915,227
5,929,598	5,930,720	5,960,358	5,987,330	6,044,281	6,070,082
6,125,277	6,253,088	6,314,278			

©2003 Uniden America Corporation, Fort Worth, Texas  
Custom manufactured in China.

Contains additional foreign articles.  
UCZZ01392BZ